

A faint, stylized graphic of a leaf with a central vein and several smaller veins branching out, positioned behind the text.

# Element

a green community

# Element

a green community

## Element – a green community

Building smarter, building stronger is the message that the new Element community is sending across the Gulf Coast. Hurricane Katrina devastated the Gulf Coast region, destroying homes and businesses and displacing families. Some of the damage lingers but the spirit and the courage of the people remain strong. Element is "cleaning-up and greening-up;" establishing itself with strong initiatives by building smart, safe and eco-friendly housing.

Element, a green community, is the perfect place for you and your family. Boasting of close proximity to the Gulf of Mexico, shopping and recreation, Element consists of 123 townhomes and was created with a mind toward affordable and sustainable living. The homes feature 3 bedrooms, 2.5 bathrooms and a 1 car garage. With access to the beach just blocks away, Element is a place where you can truly experience the beauty of the Gulf region.

## Green Living - Rebuilding with a Purpose

Element features the latest green building practices that are good for you and the environment. With an eye toward environmental friendliness, Element is being built along the guidelines set forth in the National Green Building Standard for Homes program of the National Association of Home Builders. Element uses materials such as steel framing (which is recycled and recyclable) and blown-in foam insulation, along with "green" site design such as managed water runoff and designated green spaces.

Element is designed to be an energy efficient, eco-friendly community that will reduce the costs of living for its residents through the reduction in energy consumption. Smart building practices have also been utilized in the design to withstand the elements of living on the Gulf Coast.

## Green Components

- Sustainable Materials
- Energy Conserving
- Healthier Material Choices
- Operating Cost Savings





Element homes are common-wall units. Please reference site plan for townhome layout.

**FLOOR PLAN: 1,778 SF • 3 BEDROOMS • 2.5 BATHS • SINGLE-CAR GARAGE**

This quaint home features a well-designed kitchen that is open to a spacious family room. A separate, large dining room is perfect for entertaining! Enjoy the balcony from the roomy master bedroom with ample closet space and a large master bath. The laundry room is located upstairs for added convenience. This uniquely designed home is framed in steel. The interior and exterior are completed with earth-friendly materials.

Railroad St @ Hardy Ave  
Gulfport, MS 39501  
P: 866.977.4ECO (4326)  
[www.ElementCommunity.com](http://www.ElementCommunity.com)

**Element**  
a green community

**FLOOR PLAN: 1,778 SF • 3 BEDROOMS • 2.5 BATHS • SINGLE-CAR GARAGE**

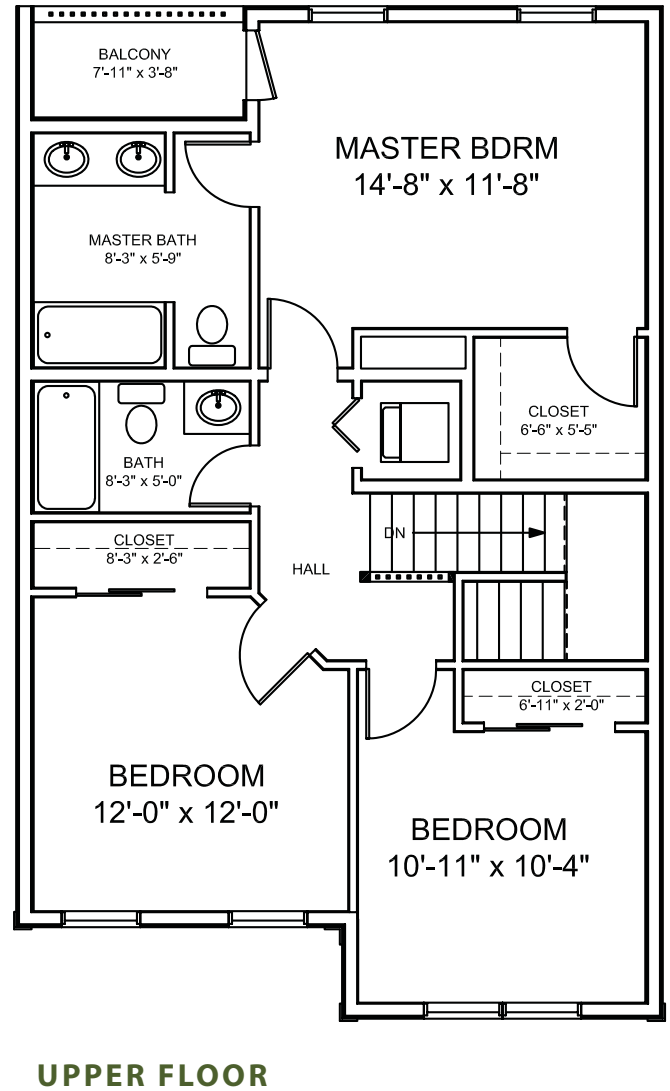
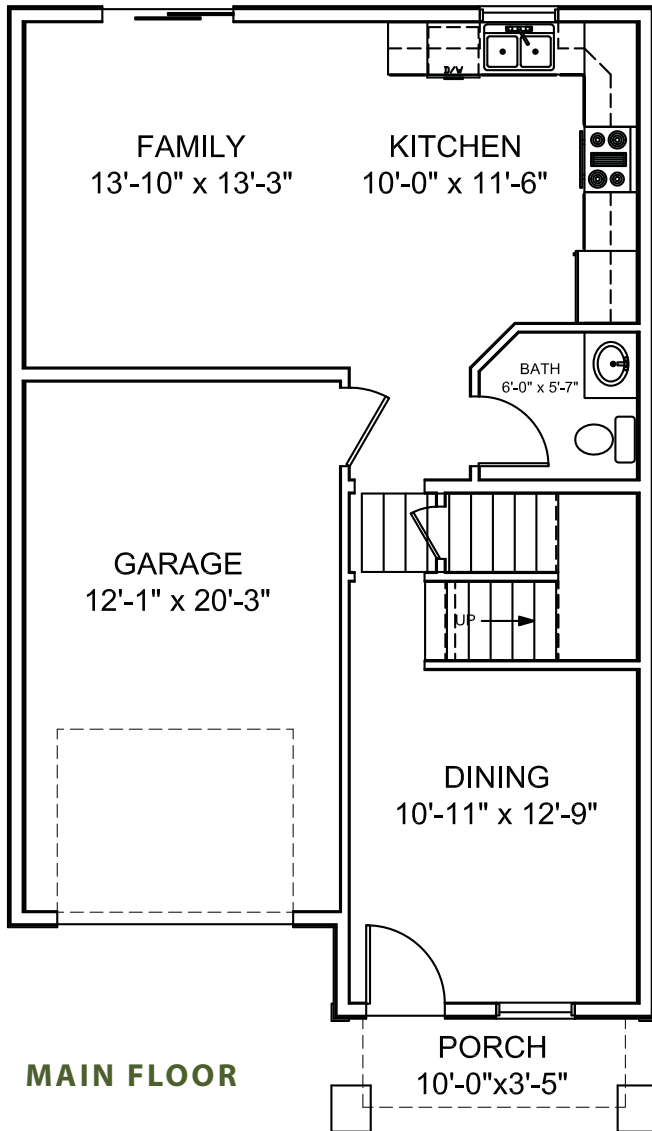

**Building Green Benefits:**

- Lower utility bills
- Greater comfort
- Improved air quality
- Made from recyclable materials
- Sustainable
- Environmentally friendly



Element homes are common-wall units. Please reference site plan for townhome layout.

**FLOOR PLAN: 1,846 SF • 3 BEDROOMS • 2.5 BATHS • SINGLE-CAR GARAGE**

This charming home features a large kitchen and dining area. The well-planned entryway welcomes guests within the spacious family room! The large master suite features a generous walk-in closet and a sizable master bath. A cozy balcony is located off of the second bedroom. The laundry room is located upstairs for added convenience. This uniquely designed home is framed in steel. The interior and exterior are completed with earth-friendly materials.

Railroad St @ Hardy Ave  
Gulfport, MS 39501  
P: 866.977.4ECO (4326)  
[www.ElementCommunity.com](http://www.ElementCommunity.com)

**Element**  
a green community

PLEASE TAKE NOTICE that the elevations, plans, specifications, materials, pricing and policies shown here may be modified without prior notice and variations may exist between the floor plans and elevations shown here and the final constructed building. All measurements are approximate and all floor plans and elevations are artist's conceptions.

**FLOOR PLAN: 1,846 SF • 3 BEDROOMS • 2.5 BATHS • SINGLE-CAR GARAGE**

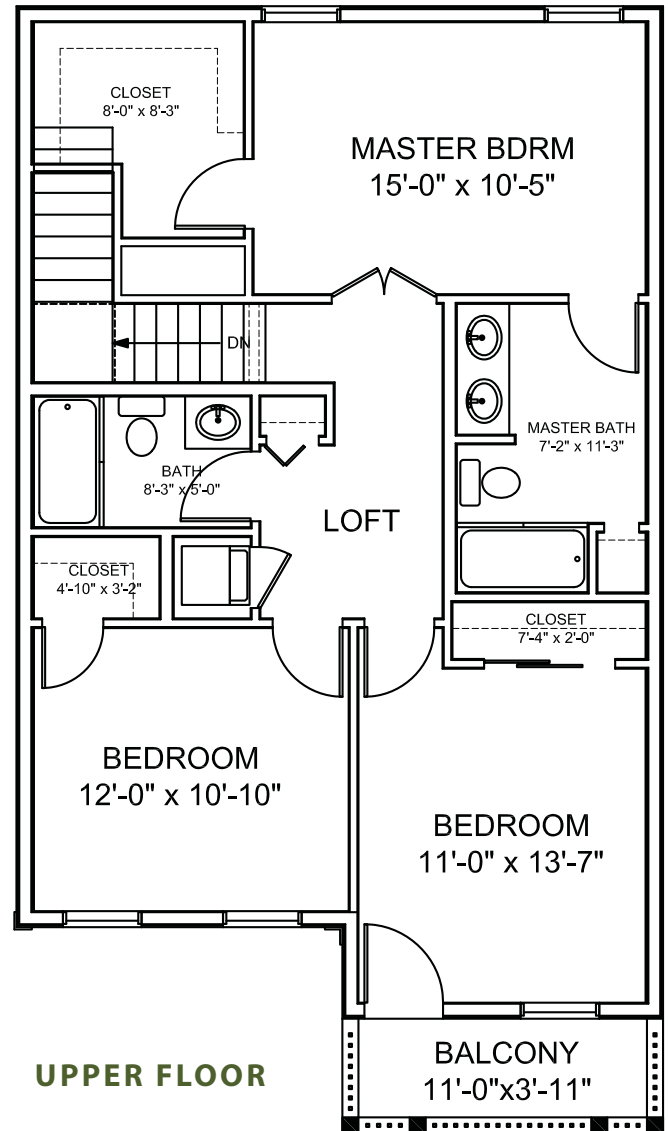
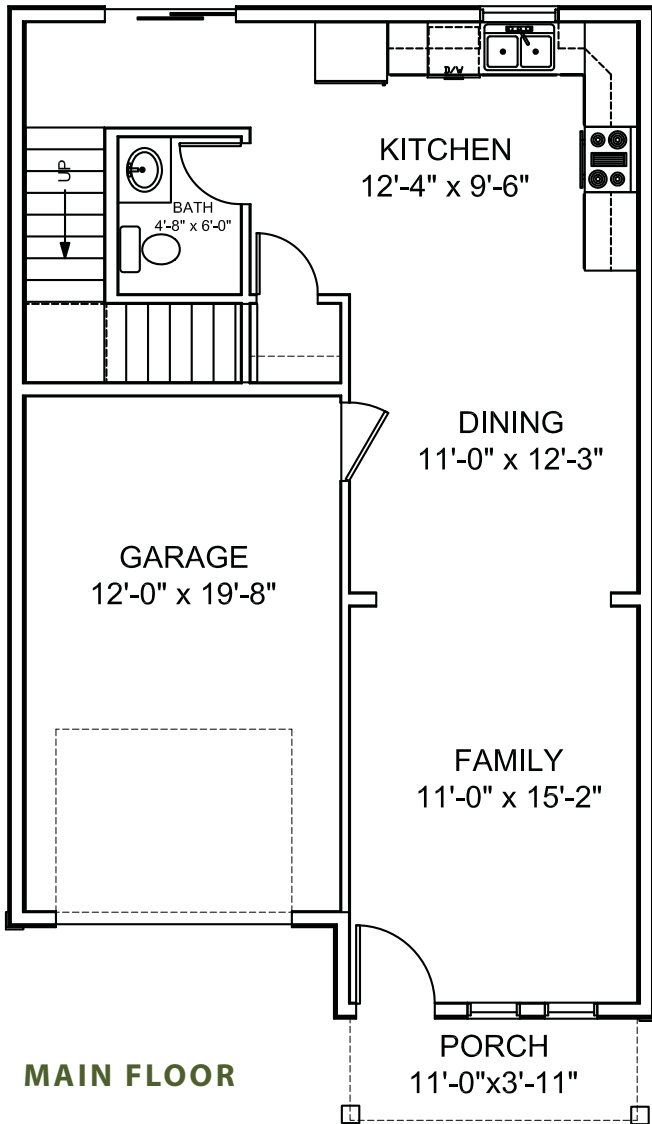

**Building Green Benefits:**

- Lower utility bills
- Greater comfort
- Improved air quality
- Made from recyclable materials
- Sustainable
- Environmentally friendly



Element homes are common-wall units. Please reference site plan for townhome layout.

**FLOOR PLAN: 1,800 SF • 3 BEDROOMS • 2.5 BATHS • SINGLE-CAR GARAGE**

A large, open family room is the focal-point of this beautiful home! An extensive master bedroom offers an oversized master bathroom with a large walk-in closet. A spacious upstairs laundry room adds convenience for the family. This uniquely designed home is framed in steel. The interior and exterior are completed with earth-friendly materials.

**FLOOR PLAN: 1,800 SF • 3 BEDROOMS • 2.5 BATHS • SINGLE-CAR GARAGE**

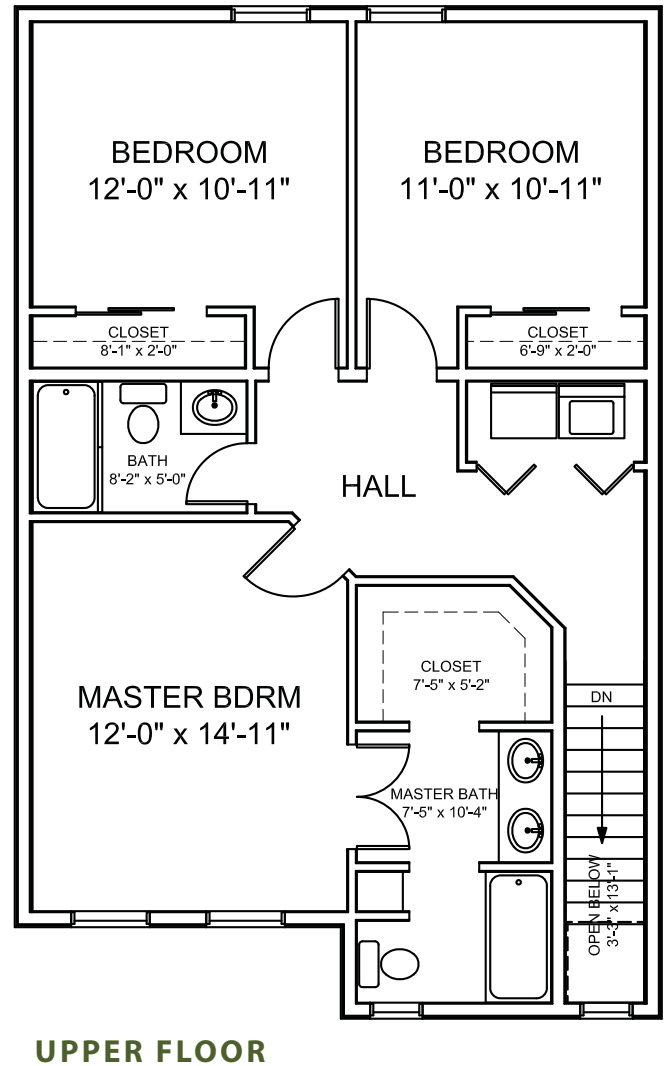
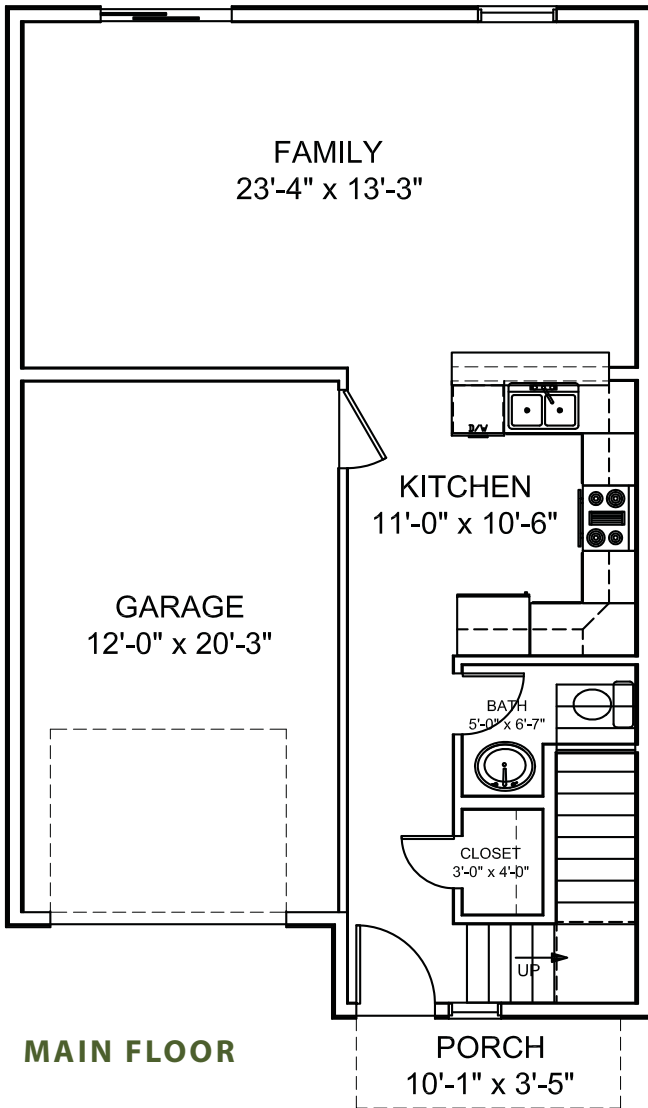

**Building Green Benefits:**

- Lower utility bills
- Greater comfort
- Improved air quality
- Made from recyclable materials
- Sustainable
- Environmentally friendly





Element homes are common-wall units. Please reference site plan for townhome layout.

**FLOOR PLAN: 1,846 SF • 3 BEDROOMS • 2.5 BATHS • SINGLE-CAR GARAGE**

This appealing home features a wonderful family floor plan with a large, open kitchen and dining room area, and a separate sizable family room. The second floor features a large master bedroom suite with walk-in closet and spacious master bath. Two large bedrooms are located upstairs for children or guests, along with a cozy balcony. The laundry room is located upstairs for added convenience. This uniquely designed home is framed in steel. The interior and exterior are completed with earth-friendly materials.

Railroad St @ Hardy Ave  
Gulfport, MS 39501  
P: 866.977.4ECO (4326)  
[www.ElementCommunity.com](http://www.ElementCommunity.com)

**Element**  
a green community

**FLOOR PLAN: 1,846 SF • 3 BEDROOMS • 2.5 BATHS • SINGLE-CAR GARAGE**

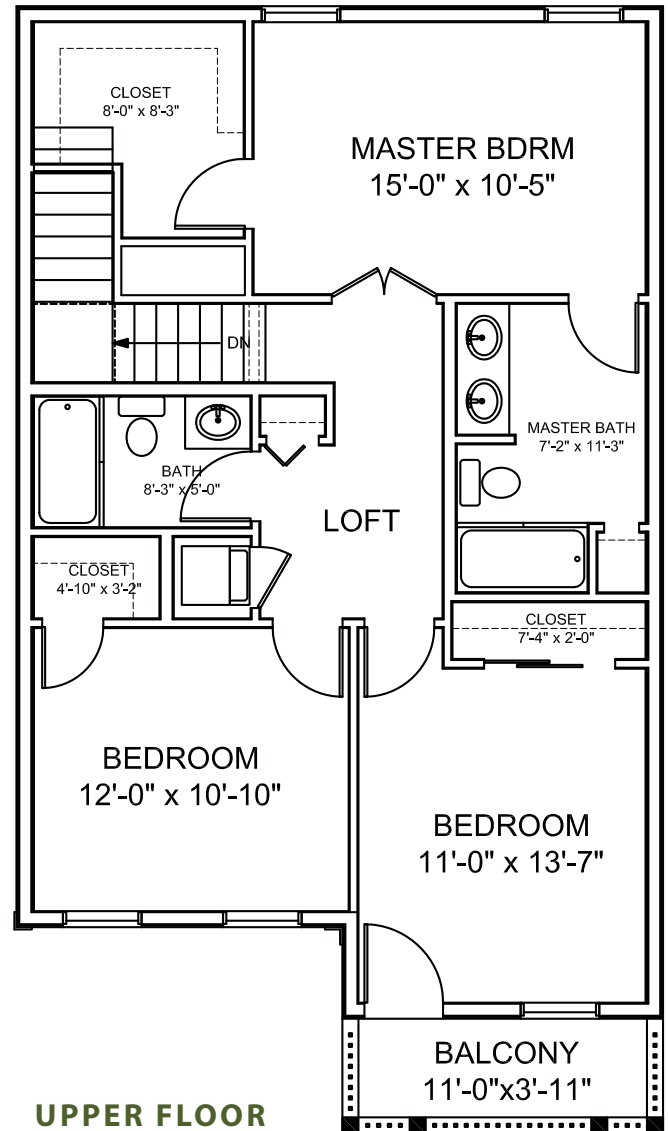
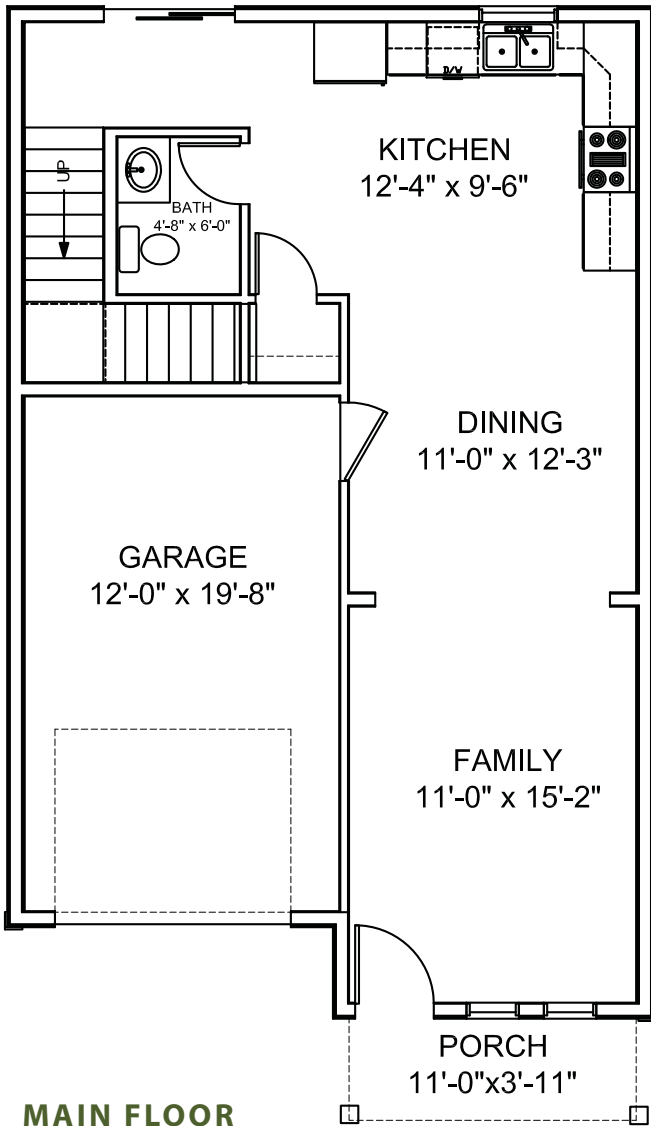

Building Green Benefits:

- Lower utility bills
- Greater comfort
- Improved air quality
- Made from recyclable materials
- Sustainable
- Environmentally friendly



Element homes are common-wall units. Please reference site plan for townhome layout.

**FLOOR PLAN: 1,793 SF • 3 BEDROOMS • 2.5 BATHS • SINGLE-CAR GARAGE**

This beautiful home possesses great curb appeal and features a spacious main floor plan for family relaxation or to entertain guests! The large master bedroom is an oasis, with its nicely appointed bath and ample walk-in closet space. An upstairs laundry room adds family convenience. This uniquely designed home is framed in steel. The interior and exterior are completed with earth-friendly materials.

Railroad St @ Hardy Ave  
Gulfport, MS 39501  
P: 866.977.4ECO (4326)  
[www.ElementCommunity.com](http://www.ElementCommunity.com)

**Element**  
a green community

**FLOOR PLAN: 1,793 SF • 3 BEDROOMS • 2.5 BATHS • SINGLE-CAR GARAGE**

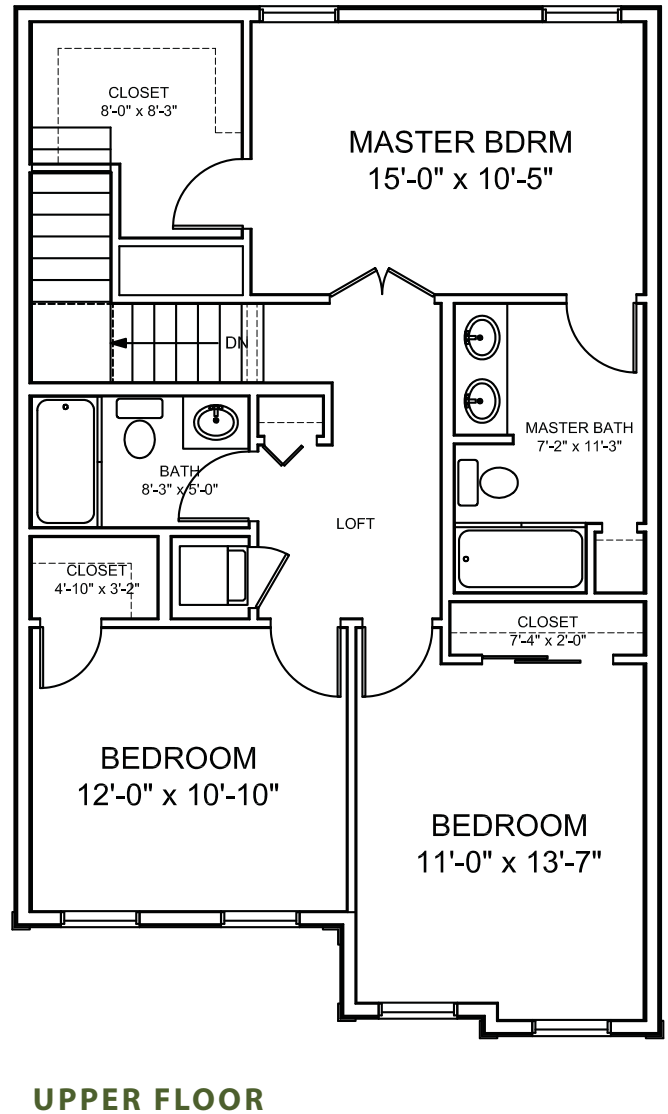
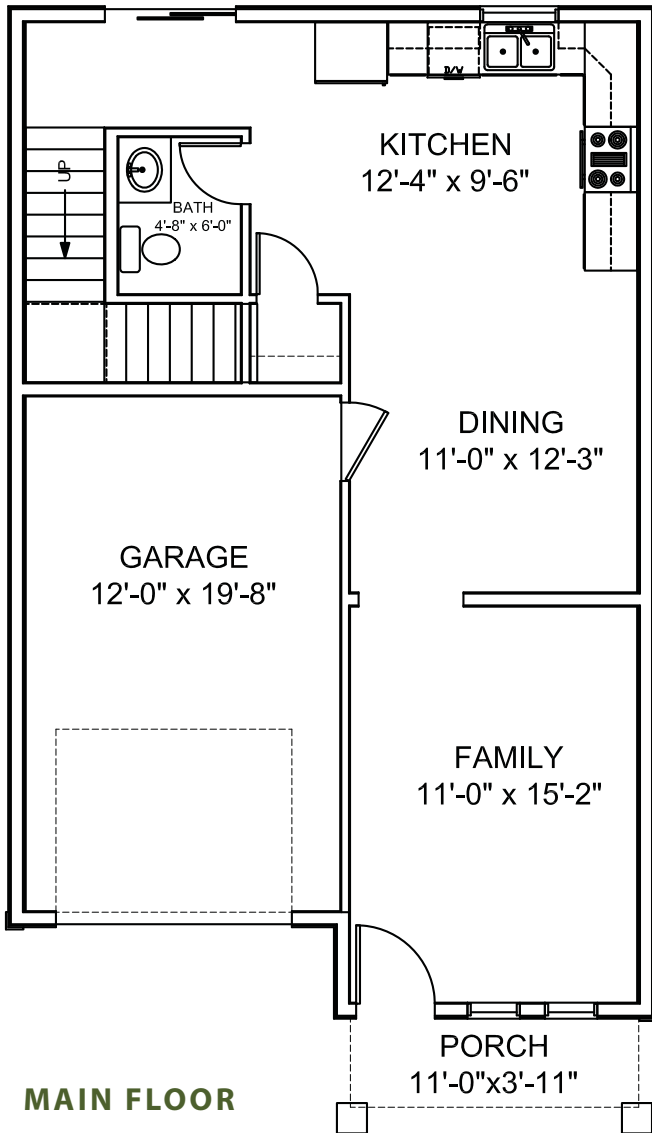

**Building Green Benefits:**

- Lower utility bills
- Greater comfort
- Improved air quality
- Made from recyclable materials
- Sustainable
- Environmentally friendly

Element Townhomes are common-wall units available in 3, 4, and 5-plex structures.  
Please reference the Community Site Plan for Townhome layout.



Railroad St @ Hardy Ave  
Gulfport, MS 39501  
P: 866.977.4ECO (4326)  
[www.ElementCommunity.com](http://www.ElementCommunity.com)

**Element**  
a green community



Railroad St @ Hardy Ave  
Gulfport, MS 39501  
P: 866.977.4ECO (4326)  
[www.ElementCommunity.com](http://www.ElementCommunity.com)

**Element**  
a green community

PLEASE TAKE NOTICE that the elevations, plans, specifications, materials, pricing and policies shown here may be modified without prior notice and variations may exist between the floor plans and elevations shown here and the final constructed building. All measurements are approximate and all floor plans and elevations are artist's conceptions.

# Element

a green community

## Financing Your New Home

We know that the finance and lending markets have changed. Element has worked hard to come up with good programs for our buyers. Special financing and affordable homeowner's insurance options are available from our preferred Lender Groups.

Now is the opportune time to get into a new home.

Whether you're a first time buyer or moving up, you can get personalized service that makes the financing process easier. We are committed to making the loan application process more convenient, and through our preferred Lender Groups, provide a wide array of financing options to help you purchase your dream home...Please call 866-977-4ECO (4326).

## Limited Opportunity for First-Time Buyers

For aspiring home owners who find their goal elusive, newly enacted legislation providing a tax credit of as much as \$8,000 for first-time home buyers might just be the opportunity of a lifetime.

But like so many good things, time is of the essence for buyers who want to take advantage of this outstanding opportunity. Only homes purchased on or after January 1, 2009 and before December 1, 2009 are eligible. **Learn more at: [www.FederalHousingTaxCredit.com](http://www.FederalHousingTaxCredit.com)**

## Assisting You With Your Dreams of New Home Ownership

Even the most experienced home buyer can find the home mortgage process hard to understand. The professional staff at Element is dedicated to assist you throughout the loan process and is always available to answer questions.

### We'll assist you with:

1. Pre-Qualification Documents
2. Loan Application Preparation
3. Choosing Rates and Points
4. Getting Your Loan to Closing



*A development designed for "green" living.*



*Made from Earth-Friendly Materials*

**Element a green community**

Railroad St @ Hardy Ave Gulfport, MS 39501 P: 866-977-4ECO (4326) [www.ElementCommunity.com](http://www.ElementCommunity.com)